

News for POSTAL VOTERS

 Conservatives

April 2019

Election of a new Councillor for Moreton and Leasowe

USE YOUR VOTE TO STOP A MILITANT- STYLE TAKEOVER

Wirral Council is on the verge of being taken over by the hard left, Militant-style Labour Party. When there was a Militant-led Council in Liverpool, investors were scared away, jobs were lost and taxes went up.

At this year's Council elections, there are just two seats in it. If Labour loses two seats, Wirral will have narrowly avoided going down the Liverpool 'road to ruin' that we saw in the 1980s.

Opinion polls show it's neck and neck between Labour and the local Conservatives.

Here in Moreton and Leasowe, Debbie Caplin needs your vote to win. Don't let Labour sneak in. Every vote will count this time.

If you have any questions about your postal vote, call the Helpline on the number below or email electoral@wirral.gov.uk.

Postal vote helpline: **0151 691 8046**

USE YOUR POSTAL VOTE FOR DEBBIE TO:

- Cut the £2.6m Labour is spending on management consultants. Page 3.
- Send a message against Labour's new Metro Mayor Tax
- Scrap the Wirral View and secure a fairer share of Council spending for our area

For the election of a councillor in Moreton and Leasowe:

DEBBIE CAPLIN
Local Conservatives



Spot the difference?

Pasture Road, Moreton

This side of the road has three Labour Councillors:

179 issues and requests for action in Leasowe & Moreton raised by Labour in 2018

This side of the road has three local Conservative Councillors:

226 issues and requests for action in Moreton & Saughall Massie raised by the Local Conservatives

Data provided by the Chief Executive of Wirral Borough Council.

our plan

SAVE OUR GREEN BELT:

Thousands of residents oppose Labour's plans to build on it. We will support development of Wirral's 'Brownfield' sites instead to provide the homes that Wirral needs.

EXPOSE TOWN HALL WASTE:

Too much of your Council Tax is being wasted by Labour on things we don't need, such as the Wirral View newspaper and management consultants.

PROTECTING OUR COASTS AND BEACHES:

We will do more to keep our beaches clean and tackle pollution. And, working with residents, we stopped Labour's coastal parking charges and tackled the camper van parking problem.

GROW OUR LOCAL ECONOMY:

There are 1,800 more businesses in Wirral than in 2010. We will do more to support our High Streets and small businesses to create the jobs and thriving local communities we need.

IMPROVING ANIMAL WELFARE:

Labour's Dog Ban Plan penalises the many responsible owners because of the actions of the few. So, we'll scrap the plan. We will also do more to tackle animal neglect and abuse.

BETTER COUNCIL SERVICES:

We will fight for resurfacing of Wakefield Drive, Stuart Avenue and others and for old street lights to be replaced with the new LED lights, with the £4.6 million given by the Government.

For the election of a councillor in Moreton and Leasowe:
DEBBIE CAPLIN
Local Conservatives



THERE ARE JUST 2 SEATS IN IT!

The outcome of the Council election in Wirral will decide whether we have a Militant-style Labour Council after May 2nd.

The 'hard left' members who have joined since Jeremy Corbyn became Leader now control the Labour Party across Wirral. Following the decision of Council Leader Phil Davies to step down in May, it is likely that his replacement will be one of those councillors as well.

All that is stopping them from controlling the Council are the 21 Conservative Councillors in the Town Hall. The other parties are too far behind and can't win.

If Labour loses just two seats in these elections (out of the 35 they hold), they won't have outright control of the Council. (A Party needs 34 seats or more to run the Council on it's own.)

That means all the parties will have to work together and only policies that have the support of a majority of



Moreton & Leasowe is one of the top seats that the Militant-style Labour Party is trying to hold

councillors will be agreed. That's why every vote - including every postal vote - matters so much.

The last time Militant Labour ran a council it was in Liverpool, with Derek Hatton in the 1980s. Their extreme policies and tactics scared away investors, leading to job losses, higher taxes and

worse local services, as well as from a reputation that took years to recover.

No matter how you vote in a General Election, locally here in Wirral, it's different this time but it's going to be close. Just two seats will decide whether your Council goes down the Liverpool road to ruin after May 2nd.

“We only hear from Labour at election time. We hear from Debbie Caplin ALL the time!”



Need help to return your postal vote?
Call 0151 691 8046 or email electoral@wirral.gov.uk

YOUR POSTAL VOTE IS ON THE WAY: **USE IT OR LOSE IT!**

Postal votes are the safest way of voting but, at every election, some votes aren't counted because they have been sent back too late or haven't been completed properly.

This guide tells you what should be in the postal vote pack that has been sent to you by the Town Hall.

The step-by-step guide also tells you how to make sure it is done correctly. Remember, you don't need a stamp to post it back. You can send it back using your nearest post box.

If you make a mistake or if you're not sure what to do, call the Postal Vote Helpline at the Town Hall on 0151 691 8046 or email electoral@wirral.gov.uk and the staff there will do their best to help.

Please remember that, at every election, there are seats that are won or lost by a handful of votes.

Don't wake up on Friday 3rd May to find that you have a Militant Labour Council - make sure you use your postal vote to elect Debbie Caplin to work for you in Moreton and Leasowe.

WHAT YOU WILL GET FROM YOUR COUNCIL

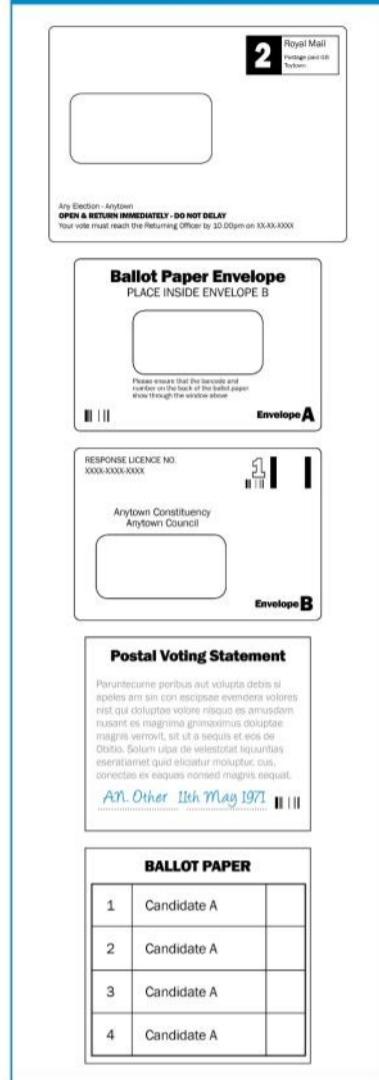

A STEP-BY-STEP GUIDE TO COMPLETING YOUR POSTAL VOTE

STEP 1

Fill in the ballot paper and put into the envelope marked "A". Now seal the envelope marked "A".



STEP 2

Sign your postal voting statement and give your date of birth, both of which will be checked against the Postal Vote Register.



STEP 3

Put the Postal Voting Statement and the sealed envelope marked "A" into the envelope marked "B" and ensure the address shows through the window.

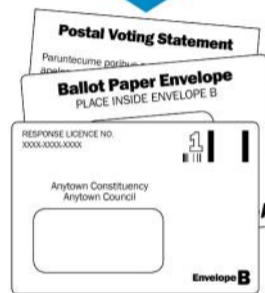

STEP 4

Post it! No stamp necessary.



REVEALED!
WIRRAL'S LABOUR COUNCIL IS SPENDING MORE ON CONSULTANTS AND SENIOR DIRECTORS:

Council chiefs in the money

Globe, 10 April 2019

A damning report by the independent Taxpayers' Alliance has named Wirral as paying higher salaries for senior directors than almost any other council in the country.

Their recent report ('Town Hall Rich List') revealed that Wirral's top seven directors had cost the taxpayer £1.4 million a year.

At the same time, Labour's use of private sector management consultants to support the Directors and the 10 member Labour Cabinet continues to grow - one individual is being paid £900 a DAY!

To put this into context, it's the equivalent of fixing every faulty street light in Wallasey.

So, the next time Wirral Labour puts a leaflet through your letterbox or knocks on your door to tell you there is 'no money', ask them why they are spending YOUR money on these top jobs. It's their political choice to do so.

Debbie Caplin and the local Conservatives have a plan to deal with this:

- 1. STOP** recruiting Directors who are paid more than the Prime Minister.
- 2. PUBLISH** the cost of the top jobs and consultants with the annual Council Tax bill.
- 3. REDUCE** the use of outside consultants and make their appointments public.
- 4. CAP** the generous pay-offs when senior directors retire or leave the Council.

If you agree with our plan, use your postal vote to vote for it at the council elections this year:

The top 3 mistakes made by postal voters:

1 TOO LATE: Don't leave it until the last minute to post it. Most people return theirs immediately to make sure.

2 NOT SIGNED: If you don't sign the Declaration that is with the ballot paper, your vote won't be counted.

3 SPOILT BALLOT: Don't put your name on the ballot paper and only mark one box on it otherwise it won't count.

WHO'S REALLY ON YOUR SIDE?

IN APRIL, CONSERVATIVES ARE:

- ✓ Raising the National Living Wage to £8.21 an hour - the highest ever.
- ✓ Increasing the amount you can earn before paying Income Tax to £12,500.
- ✓ Giving small retailers extra help by reducing their Business Rates by 33%.
- ✓ Extending support and help for people who want to start their own business
- ✓ Raising Access to Work grants by £2,000 to help more disabled people get jobs.

For more information: wirralconservatives.com

IN APRIL, LABOUR IS:

- Increasing your Council Tax to the highest-ever level.
- Spending a record amount of your money on consultants.
- Introducing the new 'Metro Mayor Tax' on every home.
- Spending £7 million to buy a cinema in Birkenhead
- Hoping you'll let them hang on to power on May 2nd

Promoted by Margaret Kallin on behalf of Debbie Caplin, both at Campaign Centre, 15d Lancelotti Precinct, Spital Road CH63 9JP and printed by Mortons Media Group Ltd, Media Centre, Morton Way, Horncastle LN96JR

For the election of a councillor in Moreton and Leasowe:
DEBBIE CAPLIN
Local Conservatives



'WE HAVEN'T LEFT LABOUR; LABOUR HAS LEFT US'

Today's Labour Party - of Corbyn, McDonnell and Militant - is not the same Labour Party that our parents and grandparents voted for.

In their own words, Labour MPs, councillors and members explain why they have called it a day:

BIRKENHEAD MP, FRANK FIELD: "It (Labour) has allowed a culture of nastiness, bullying and intimidation to develop".

- quit Labour in September

POLICE COMMISSIONER JANE KENNEDY: "I left the Labour Party after the resignation of Luciana Berger MP and the announcement that Derek Hatton had been re-admitted into party membership"

- quit Labour in March

LABOUR COUNCIL LEADER PHIL DAVIES: "the local party has been taken over by a small group of hard-line extremists that are pursuing a narrow ideological agenda."

- quits as Leader in May

LOCAL ACTION FOR MORETON AND LEASOWE

Labour pops up at election time while the smaller parties don't even bother then! Only the local Conservatives led by Debbie Caplin keep in touch all year round. We can't promise to solve every problem, but we will try our best.



Coastal parking fees:

Working with Councillor Chris Blakeley, Debbie opposed Labour's plans to introduce car parking fees at Leasowe Common, keeping it free for everyone to enjoy.



Fighting for Green Belt:

Debbie, seen here at the former Upton Park on Sandbrook Lane with Ian Lewis, opposes development on our green and open spaces. Much of our area is already prone to flooding.

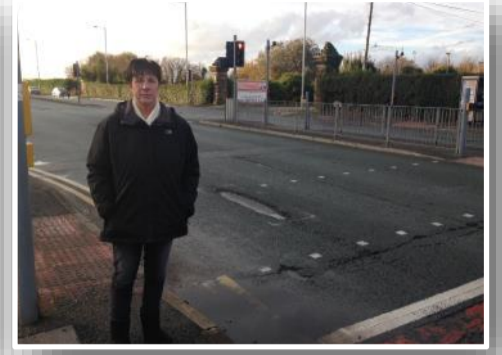

Road repairs:

Last year, the Labour Councillors failed to secure a single penny for 'structural road repairs'. So far, thanks to Debbie pot holes on Leasowe Road have been fixed but more is needed.



Parking charges:

Working with traders in Moreton, we helped to stop Labour's plans for parking charges but, sadly, were outvoted when it came to parking enforcement at the Home Bargains car park.



Play areas:

While Ian Lewis helped to raise £150,000 for local play areas, not much has happened since. Debbie is pushing the Town Hall to bid for a share of a £13 million Government fund for parks.



Sandbrook litter pick:

One of the top issues is the amount of litter and rubbish. Debbie organised a litter pick and is also petitioning for action on dog fouling around Sandbrook Primary School.

USE YOUR POSTAL VOTE TO MAKE A DIFFERENCE:

The council election here in Moreton and Leasowe is between Debbie Caplin and an increasingly hard-left and extreme local Labour Party.

The smaller parties are too far behind and can't win here.

A 'protest vote' for them, or not voting at all, only makes it easier for Labour to win here on 2nd May.

DEBBIE CAPLIN: MY FIVE PLEDGES TO THE PEOPLE OF MORETON AND LEASOWE

At a time when trust in national politicians and MPs has never been lower, we think it's important that you know where we stand and how we'll serve you, if you elect Debbie:

1. Debbie will always put the interests of **Moreton and Leasowe first**.
2. Debbie will be **accessible and visible** across the community with regular newsletters and surveys.
3. We will **consult** local residents on important issues, such as our recent survey on parks and play areas.
4. We will work with and **support local organisations** such as tenants associations and environmental groups
5. We will always act with **integrity and honesty** and won't make promises we can't keep.

CONTACT DEBBIE ON ANY LOCAL ISSUE OR TO PLEDGE YOUR VOTE ON MAY 2:

Email: debbielynsaycaplin@gmail.com Phone: 07436 799967 Write: 39 Alwick Drive, Moreton CH46 6ET